

Selected Fan
n Max

TLZ 560
1200 1/min

Fan working conditions
Pw Max

Free Inlet - Free Outlet
13.50 kW

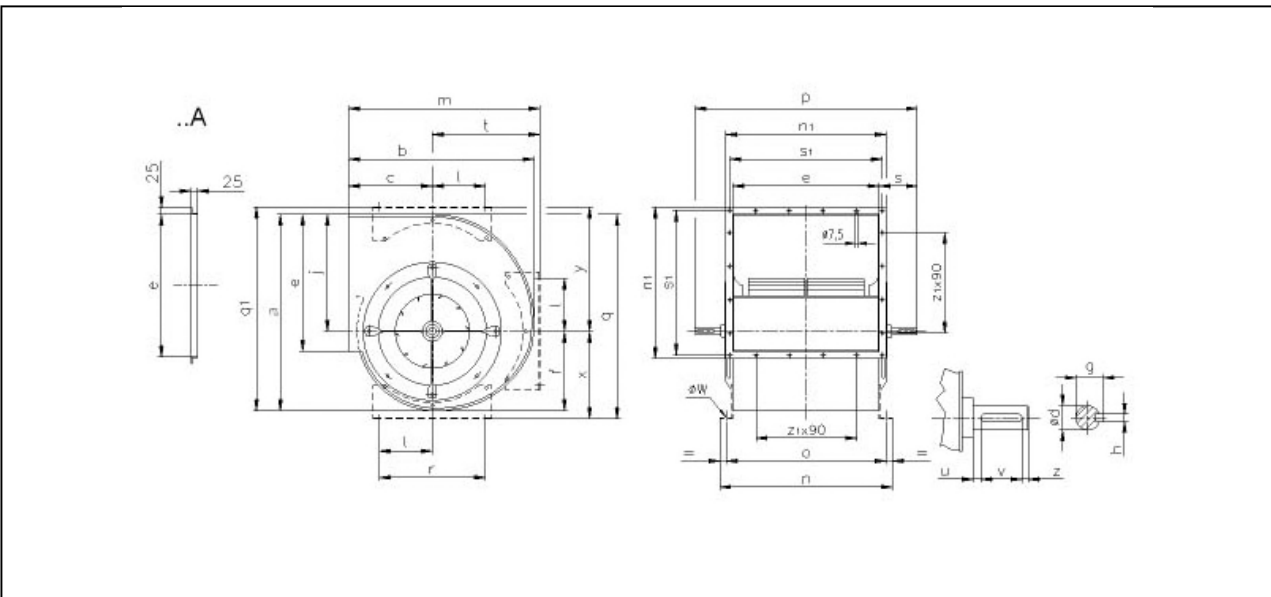
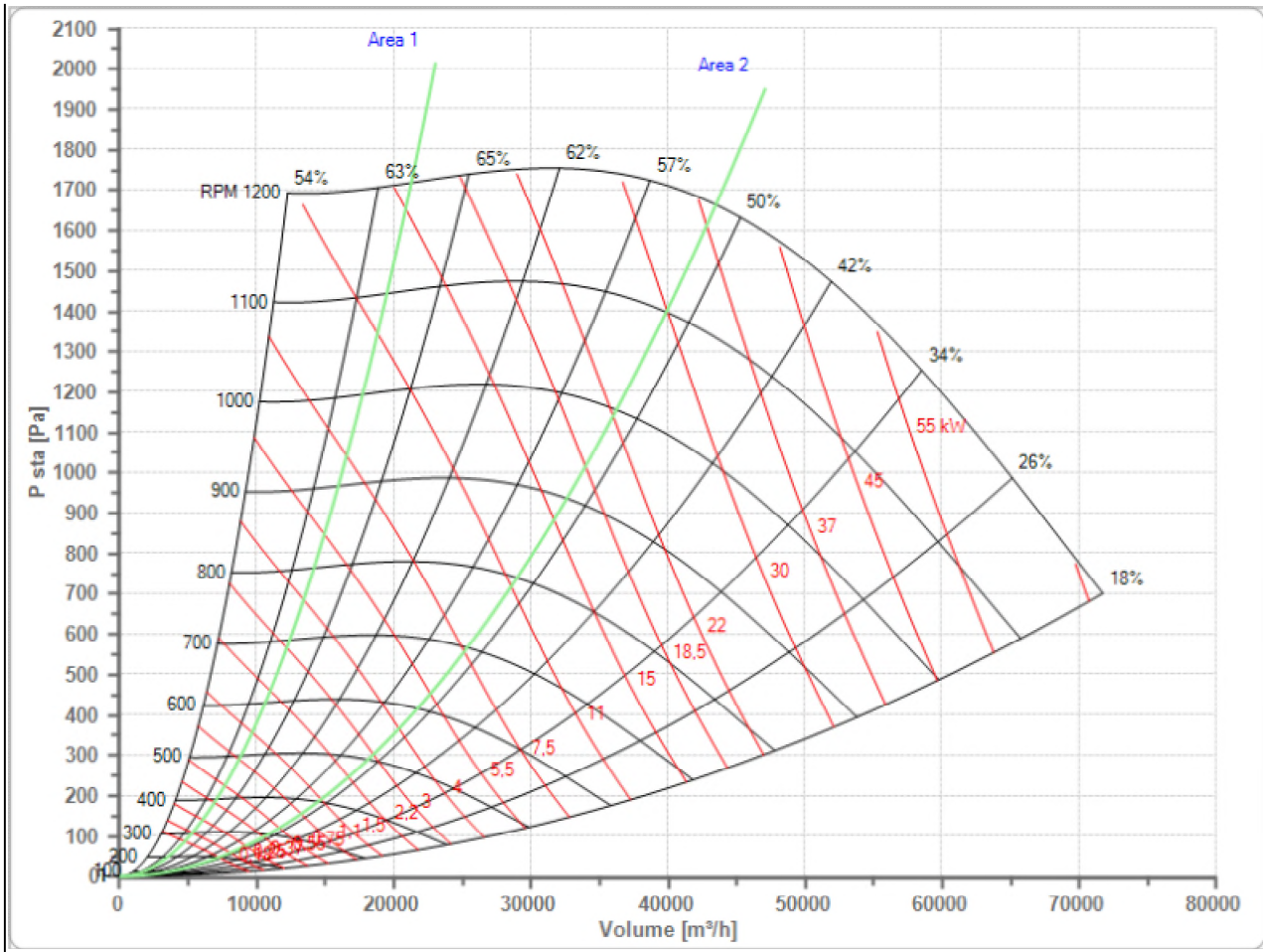

| | | | | | | | | | |
|------|-----|-----|-----|-----|------|------|------|-----|-----|
| a | b | c | e | f | g | h | j | l | m |
| 1017 | 887 | 390 | 715 | 412 | 43 | 12 | 606 | 250 | 892 |
| n | n1 | o | ød | øw | p | q | q1 | r | s |
| 815 | 765 | 765 | 40 | 15 | 1000 | 1022 | 1046 | 500 | 143 |
| s1 | t | u | v | x | y | z | z1 | | |
| 745 | 502 | 10 | 70 | 416 | 634 | 10 | 7 | | |