

Selected Fan  
n Max

**THLZ 315 FF**  
**3700 1/min**

Fan working conditions  
Pw Max

**Free Inlet - Free Outlet**  
**5.60 kW**

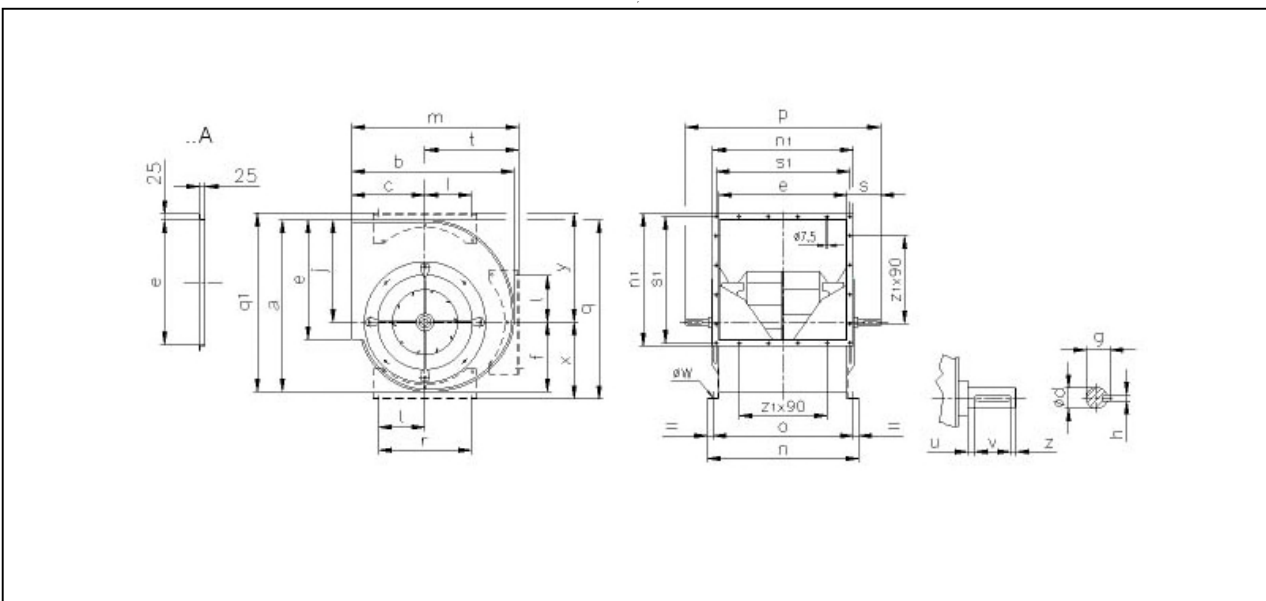
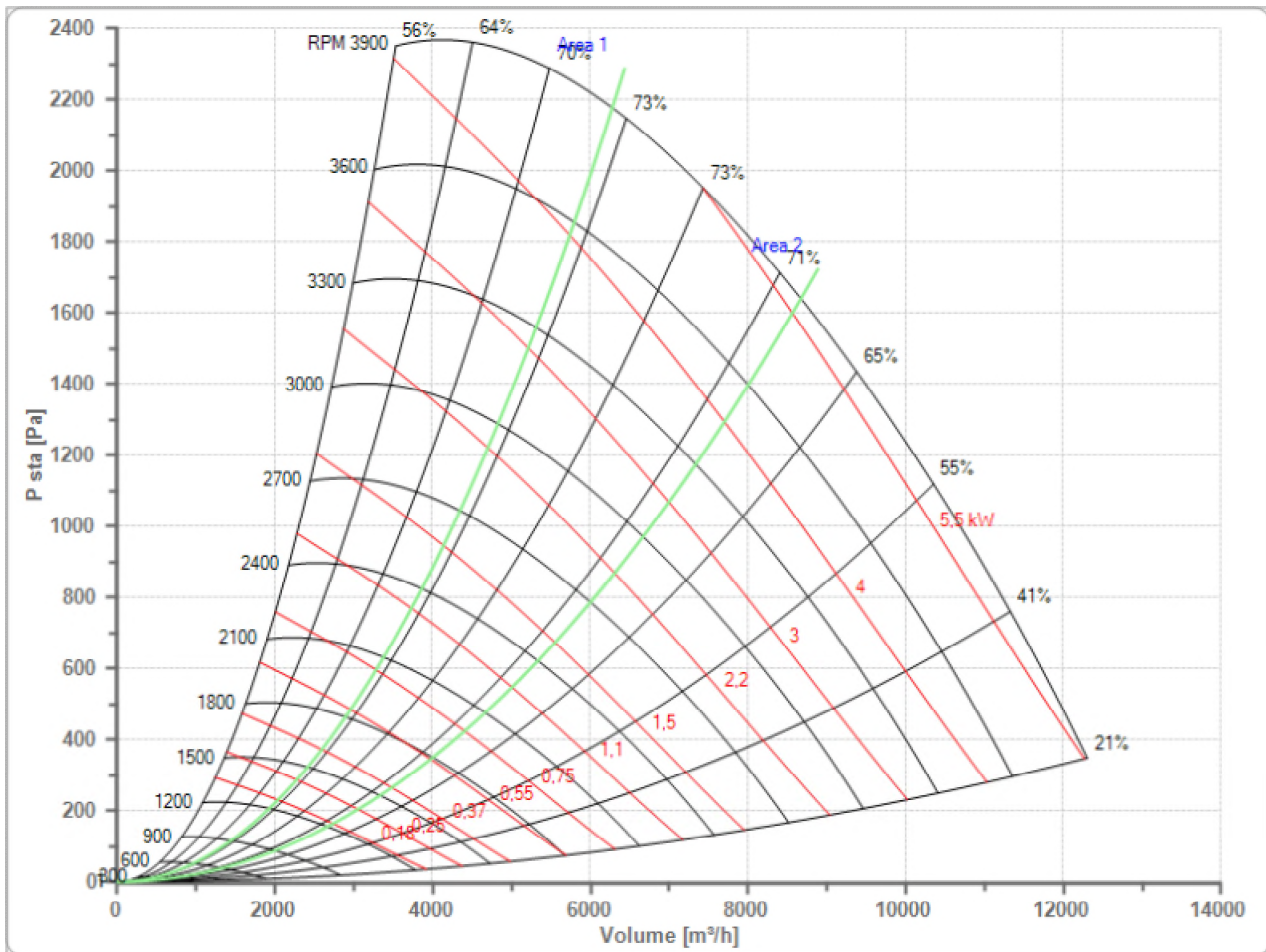

a	b	c	e	f	g	h	j	l	m
573	516	236	404	233	28	8	341	140	516
n	n1	o	ød	øw	p	q	q1	r	s
464	454	434	25	10.5	585	600	771	280	90
s1	t	u	v	x	y	z	z1		
434	280	5	40	258	367	5	4		